

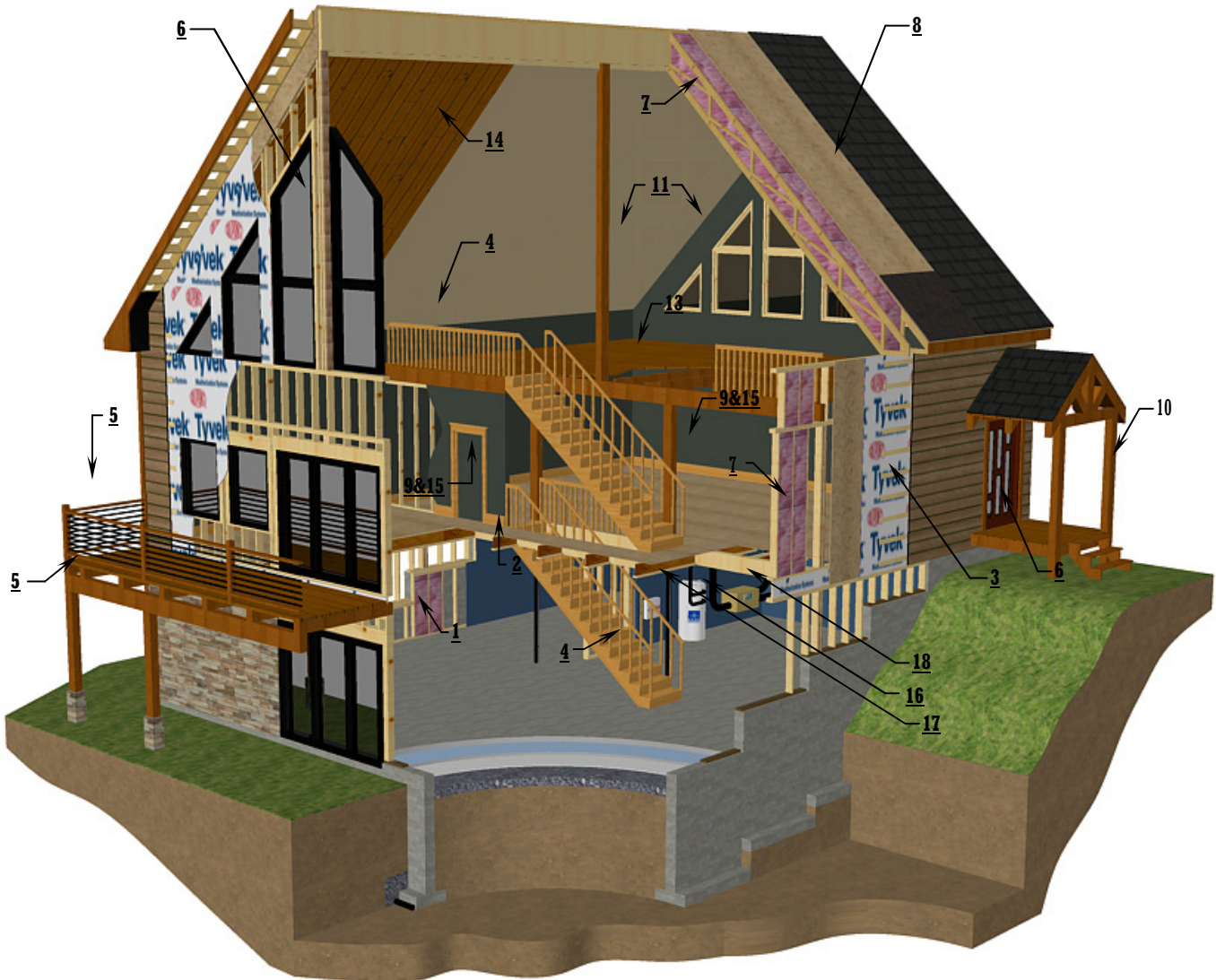

Pre-Engineered Custom Home Packages that are energy-efficient & eco-sustainable

Available in conventional, Hybrid Posts and Beams and Log

Paragon standard Kit Details and Options



Available in Conventional, Hybrid Post & Beam or Log



Our [home packages/kits](#) are produced with pre-engineered wood from [Ilevel](#). The structure is entirely engineered by our own technologists and engineers. Energy efficiency of our home packages are in accordance with [Energyguide \(rated above 80\)](#). They are also carbon neutral (Reduces greenhouse gas emission). We [meet and beat the one-tonne challenge!](#) Your new home will be produced and built with the standards of [Energy Star](#).

***Energy-efficient homes in accordance with recommendations in the Office of Energy Efficiency's *EnerGuide*.

Included in the Kit:

1) Basement/walk-out walls (Including division walls):



- Building paper 15# on concrete wall
- 2" x 4" KD studs
- R-12 insulation
- 6 mil. poly vapor barrier
- 1" x 3" strapping

2) Floor structure/system for main and second floor:



- Adjustable column as per plans
- All [LVL](#), [Microllam](#) & [Parallam](#)
- Steel beams as per plans (if applicable)
- [T.J.L. floor system](#) by Weyerhaeuser/Level
- 3/4" [OSB Edge Gold](#) floor sheathing by Weyerhaeuser/Level

3) Exterior walls (including interior division walls):



- Siding of your choice c/w trims
- Stone from [Cultured stone](#)
- 1" x 3" strapping
- Building paper (Tyvek)
- 7/16 OSB sheathing (Aspenite)
- 2" x 6" Kiln dried studs
- R-20 insulation
- 6 mil. Poly Vapor Barrier
- 1" x 3" Strapping
- Drywall 1/2"

4) Interior stairs & rails:



- Interior stairs & rails

5) Exterior decks & rails:

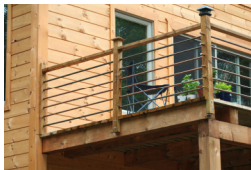

- All rails, banisters, posts and decking
- 6" x 8" pine posts, joists & rims
- 6" x 12" pine beams
- 2" x 6" cedar decking
- *** Rails of your choice
- *** No stairs included

6) Energy Star Windows & doors:

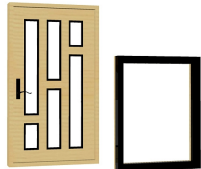

- Energy star windows
- Steel, fiberglass or wood doors
- Exterior patio doors up to 12'-0"

7) Insulation package:

- Minimum Energy star standard



NOT included in the kit/package:

Foundation ~ Framing ~ Site prep ~ Plumbing ~ Heating/Electrical ~ Floor covering & installation other than specified ~ Kitchen cabinets and vanities ~ Garage door ~ Well and septic system ~ Lighting fixtures ~ Plumbing fixtures ~ AC ~ All hardware ~ Door knobs ~ Nails & locks ~ Shelves ~ Caulking ~ Chimney cap ~ Eco package installation ~ Stairs and rails installation ~ All installation of items in kit

8) Exterior roofing:

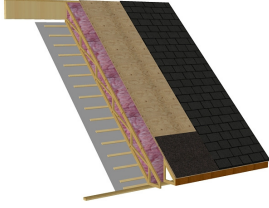

- 30 years minimum roofing shingles or metal roofing
- 45 pound asphalt roofing paper
- Ice and water shield
- 1/2" plywood
- Minimum of R-40 Insulation
- [Pre-engineer roof trusses](#)
- 6 mil. Poly vapor barrier
- 1" x 3" furring
- Drywall 1/2" or option of 6" T&G wood ceiling
- All vents & flashing
- Chimney chase
- Aluminum soffit and fascia



9) Interior doors and trims:

- Standard MDF doors and MDF trims



10) Stain package

- [Perma-Chink stain](#) or [Sansin Stain](#)



11) Interior paint:

- All Eco paint required, stain, varnish & Danish oil

OPTIONS:



12) Non Structural hybrid timber:

- 6" x 8" & 6" x 12" pine trusses & beams
- 6" x 8" pine posts
- 6" x 8" or 6" x 12" pine wall rims



13) Structural post & beam floor:

- 6" x 8" wood posts
- 6" x 8" wood joists
- 6" x 12" wood beams
- Metal hangers & braces from [Simpson Strong-Tie](#)
- 2" x 6" pine flooring



14) Interior pine ceiling:

- 1"x6" pine ceiling

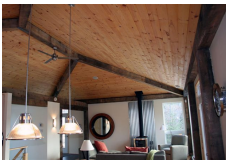

15) Interior pine doors:

- Interior pine doors and pine trims

NOT included in the kit/package:

Foundation~ Framing~ Site prep~ Plumbing~ Heating/Electrical~ Floor covering & installation other than specified~ Kitchen cabinets and vanities~ Garage door~ Well and septic system~ Lighting fixtures~ Plumbing fixtures~ AC~ All hardware~ Door knobs~ Nails & locks~ Shelves~ Caulking~ Chimney cap~ Eco package installation~ Stairs and rails installation~ All installation of items in kit.

ECO PACKAGE (OPTION):



16) Grey water recycling system:

- Grey water recycling system from [Brac System](#)
Model: RGW-150



17) Hot Water tankless system:

- [Bosch](#) AquaStar Tankless Water Heater
Model: 2400ES



18) Heat recovery ventilation (HRV):

- [Venmar AVS](#) Heat recovery ventilation (HRV)



***Available wood species (optional):

- White and red pine
- White and red Cedar
- BC or douglas Fir

NOT included in the kit/package:

Foundation ~ Framing ~ Site prep ~ Plumbing ~ Heating/Electrical ~ Floor covering & installation other than specified ~ Kitchen cabinets and vanities ~ Garage door ~ Well and septic system ~ Lighting fixtures ~ Plumbing fixtures ~ AC ~ All hardware ~ Door knobs ~ Nails & locks ~ Shelves ~ Caulking ~ Chimney cap ~ Eco package installation ~ Stairs and rails installation ~ All installation of items in kit.

Paragon wall system (as option)



- 1- 1/2" Drywall
- 2- Interior Furring 1"x3"
- 3- Vapour Barrier
- 4- 2"x6" Studs
- 5- Roxul Insulation
- 6- Aspenite (OSB) 7/16"
- 7- 1-3/4" Isoclad
- 8- Exterior Furring 1"x3"

Total R Value: 33.01 +

Five walls options:

Conventional	R-20
Paragon Standard	R-22.5
Novoclimat (Quebec)	R- 24.5
Energuidé (Ontario)	R-29
Paragon Wall System	R-33.01

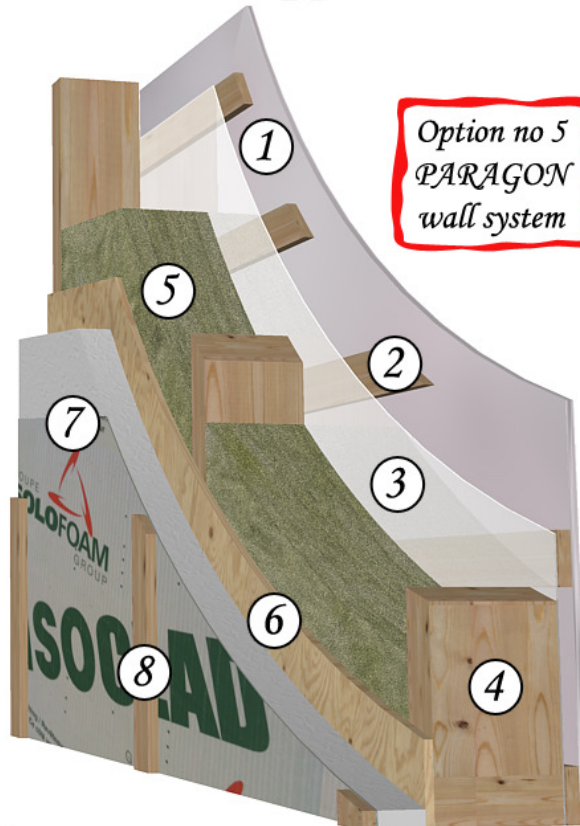

Copyrights: Maisons Paragon Homes Inc & Maisons Canadalog & Hybrid Timber Homes Inc.

Copyrights: Maisons Paragon Homes Inc. & Maisons Canadalog & Hybrid Timber Homes Inc.

Revision : June 2011